

Proposed Ground Floor Plan
SCALE 1:60 @ A3

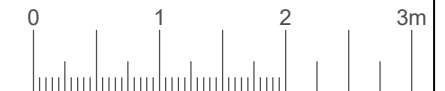

- General notes:
1. Technical specifications or specific instructions on drawings take precedence over these notes.
 2. Scaling permitted for planning purposes only.
 3. Unless noted otherwise, all dimensions are in millimetres (mm) and all levels are in metres (m).
 4. Details dimensions and levels to be checked on site by the contractor prior to commencement of works. Any works commenced prior to all necessary local authority approvals are entirely at the risk of the owner and contractor.
 5. Set out dimensions and levels shown on the drawings shall be verified by the contractor and refer to architectural drawings. The engineer shall be notified of any discrepancies prior to construction.
 6. Structural details are subject to exposure of existing construction and verification by Local Authority Surveyor (LAS) and any necessary revised details are to be agreed with the LAS prior to carrying out the affected works.
 7. All materials are to be used in accordance with the manufacturers' guidelines and all relevant British Standards Codes of Practice & Regulation 7 of Building Regs.
 8. All works are to be carried out in accordance with Local Authority requirements.
 9. The intended works fall within the Party Wall Act 1996 and any adjoining owners affected must be notified prior to commencement of any works.
 10. Thames Water Authority permission to be obtained if building over or adjacent to sewers within 3 metres. (Tel:08459 200 800)
 11. No part of the extension to project into adjoining boundary lines.

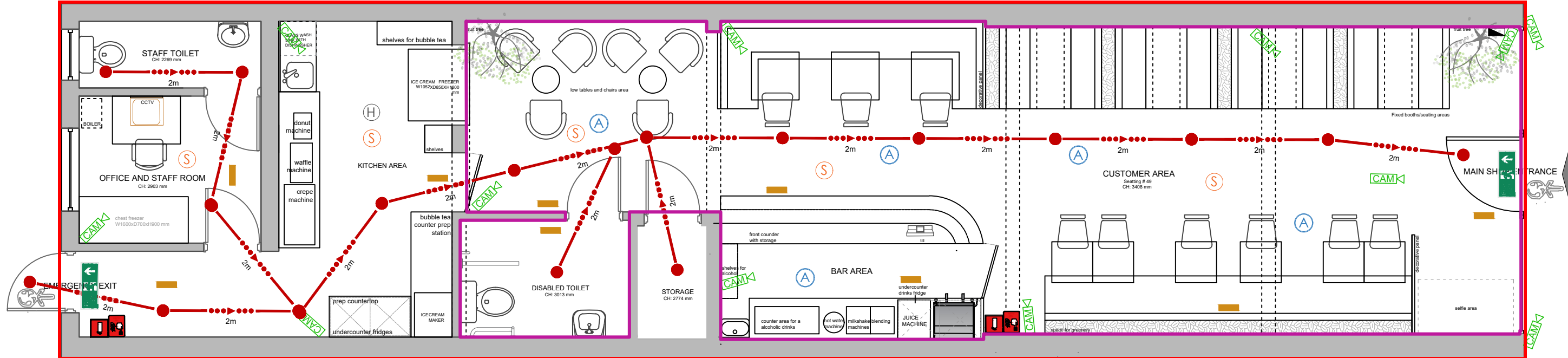

FIRE PRECAUTIONS	LEGEND:
<p>This drawing is indicative only. Refer to specialist Electrical Sub-contractors draw sets and specifications for full details of the alarm system and product set. All the work done to be constructed in accordance with BS 4743 Part 22 for the British Standard in force when the chart was manufactured.</p> <p>All the doors and that are doors through which a person may have to pass on their way out of the premises to use the escape route to be marked and maintained that they can be easily and immediately opened from the inside without the use of the key.</p> <p>Exit other than those in normal use for signs should be marked and readily visible so that the occupants of the building can clearly and readily see where the exits are and where to go in an emergency at any time. The safety signs and notices to comply with the relevant requirements of BS 5499 (Part 1 - 1999).</p> <p>ONE HOUR FIRE PROTECTION MUST BE PROVIDED TO COMPLY WITH BUILDING CONTROL.</p> <p>Licensable Area</p> <p>Key</p> <p>VP Fire Exit Sign Direction of Fire Exit used typically at change in corridor direction</p> <p>VP Wash Pan Chair</p> <p>Doors to have 60 mins (min) fire rating with smoke seals and intumescent strips</p> <p>Fire Exit - Door / way leading to outside</p> <p>Escape Tower/Distance</p> <p>Licensable Area</p>	<p>FIRE ALARM PANEL</p> <p>SINGLE SWITCHED WALL SOCKET</p> <p>DOUBLE SWITCHED WALL SOCKET</p> <p>SINGLE SWITCHED WALL SOCKET</p> <p>DOUBLE SWITCHED WALL SOCKET</p> <p>SINGLE SWITCHED FUSE SWIR</p> <p>SINGLE SWITCHED FUSE SWIR BELOW WORKTOP LEVEL</p> <p>SINGLE SWITCHED FUSE SWIR AT HIGH LEVEL FOR EXTRACT FAN</p> <p>DOUBLE SWITCHED FLOOR SOCKETS</p> <p>1 GANG LIGHT SWITCH</p> <p>2 GANG LIGHT SWITCH</p> <p>3 GANG 3 WAY LIGHT SWITCH</p> <p>3 GANG 3 WAY LIGHT SWITCH</p> <p>3 GANG 3 WAY LIGHT SWITCH</p> <p>1 GANG FULL CORN LIGHT SWITCH</p> <p>EXTERNAL LIGHT</p> <p>EXTERNAL LIGHT - BRUARD TYPE</p> <p>RECESSED DOWNLIGHTER</p> <p>WALL LIGHT</p> <p>LIGHT POINT - PENDANT HOLDER 6 INCH</p> <p>LIGHT POINT - PENDANT HOLDER 8 INCH</p> <p>LIGHT POINT - BATTEN HOLDER</p> <p>ELECTRICAL - SECURITY CAMERA</p> <p>EMERGENCY LIGHT</p> <p>FIRE ALARM CALL POINT</p> <p>EXTINGUISHER & FIRE BLANKETS</p> <p>TV Aerial Point</p> <p>IMMERSION HEATER AND THERMOSTAT</p> <p>MECHANICAL EXTRACT FAN</p> <p>DOOR BELL PUSH</p> <p>DOOR BELL CHIME</p> <p>THERMOSTAT</p> <p>SECURITY ALARM</p> <p>CONSUMER UNIT</p> <p>TELEPHONE POINT</p> <p>CAT 5 or 6 DATA SOCKET</p> <p>COOKER SWITCH</p> <p>MECHANICAL EXTRACT FAN</p> <p>COOKER HOOD</p> <p>COOKER HEAT DETECTOR</p> <p>FIRE ALARM SOUNDER</p> <p>COOKER HOOD HEAT DETECTOR</p> <p>DETECTION (WIRELESS) FIRE ALARM SOUNDER</p> <p>ALCOHOLISM</p> <p>RADIATOR</p> <p>CAT 5E</p> <p>2 CORE SPEAKER CABLE</p> <p>UNDERFLOOR HEATING MANIFOLD</p> <p>ALCOHOLISM</p> <p>FIRE EXITS</p> <p>CCTV</p>

Eagle House 163 City Road,
London, EC1V 1NR

Forbidden Fruit

Address:
2 New Parade, Church Road, Ashford, Surrey, TW15 2UF

Client:
Tinashe Chiwakata

Title:
Fire Safety/ License Plan

Stage:
Proposed Plans

Drg No:
0016

Drawn by:
EAV

Scale:
1:60 @ A3

19.02.2023

GENERAL NOTES:
Drawings To Be Read In Conjunction With Relevant Drawing And Specs.
All Dimensions To Be Checked On Site.
Contractor To Check Site Thoroughly & Report Any Discrepancies.
Any Discrepancies Are To Be Pointed To The Agent.
No Responsibility Will Be Taken For Works Which Are Unforeseen And For Any Subsequent Alterations Made Which Are Beyond The Control Of The Agent.
This Drawing Shall Not Be Used For Building Regulations And / Or Construction Purposes.